

BioTec+ 2

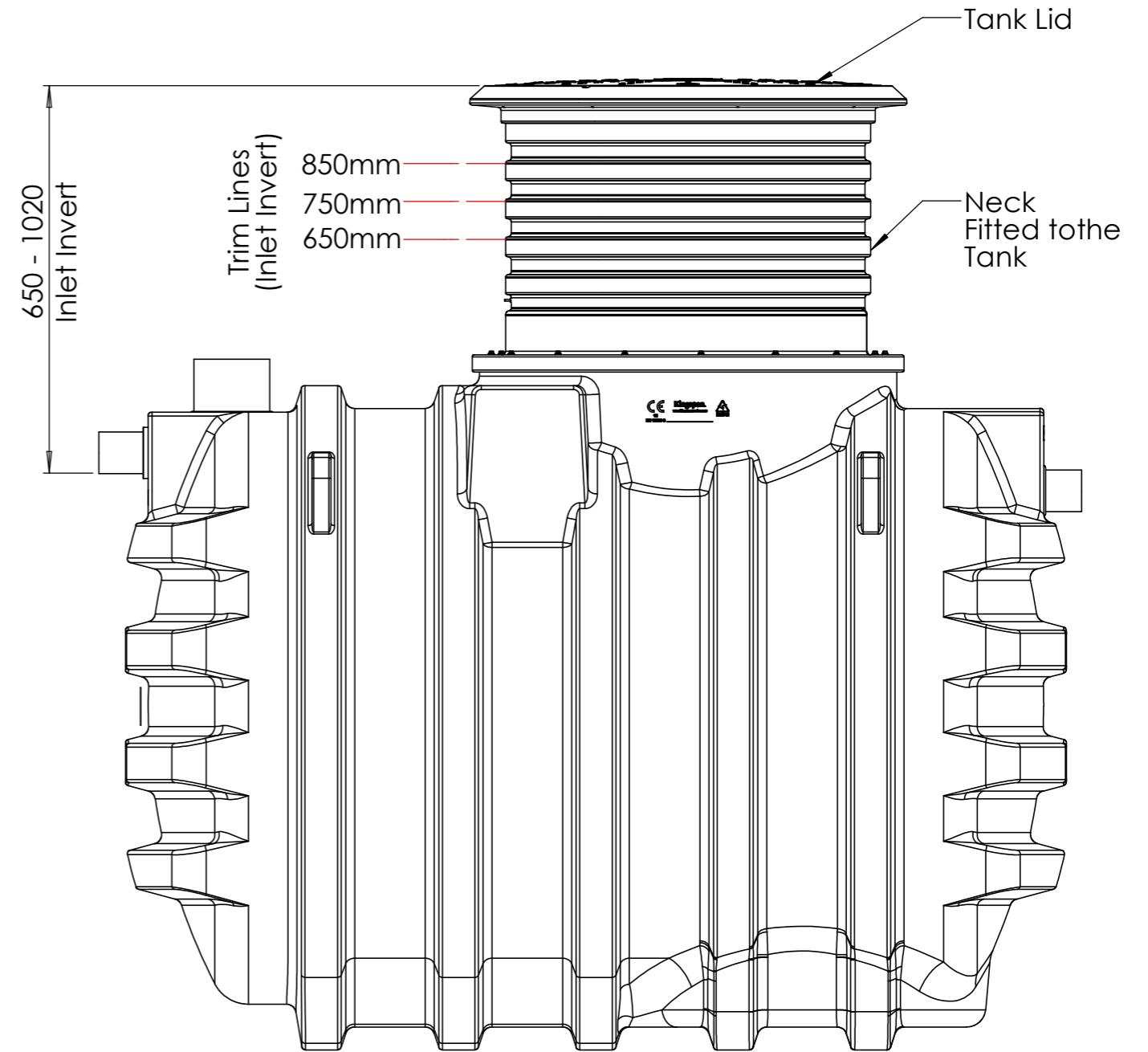

BioTec+ 3

Please check with Kingspan Water & Energy for the latest Issue of the drawing

Issue	Date	Drawn By	Approved By	Description
03	06/12/2024	D.Musvaburi	D.M	ECN 2150
02	25/10/2024	D.Musvaburi	D.M	ECN 2113
01	09/07/2024	J.Belovic	D.M	Initial Issue

Modelled By :
Weight :
Material :

Tolerance (unless stated) :
Thickness :
Surface Area : m²

Drawing : DS1482P

BioTec+2 & 3 Neck Extension/Trimming Detail

All Dimensions In mm Scale: Do Not Scale

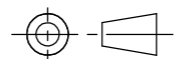

Third Angle Projection

Kingspan Water & Energy reserve the right to alter the details of this drawing without prior notice. This drawing is copyright and may not be reproduced or used without the written permission of Kingspan Water & Energy



Step 1

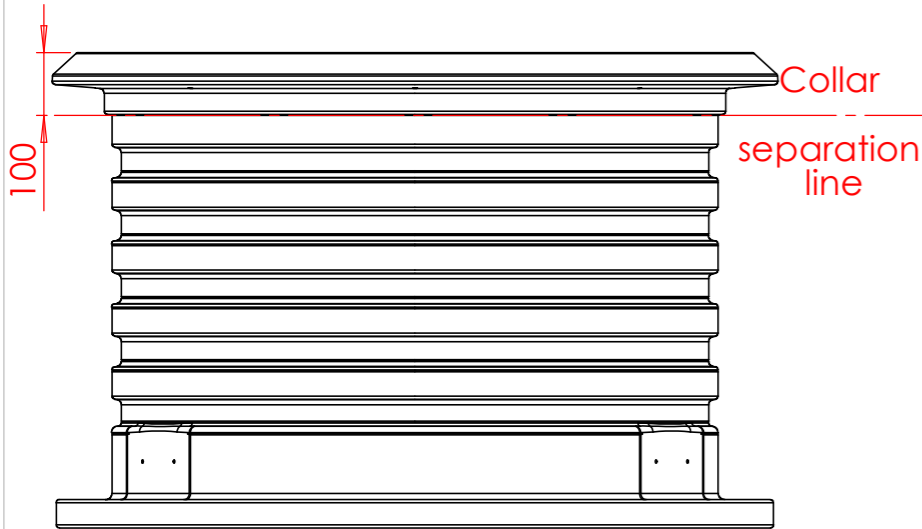

Separate the Neck collar and the base by cutting along the collar separation line.

Neck Trimming Detail

Step 2

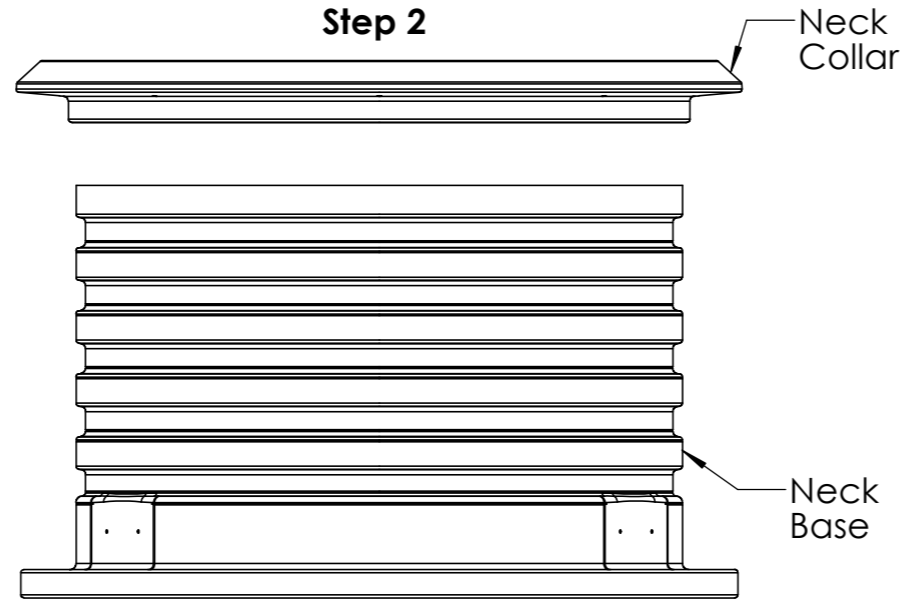

Separated Neck collar and the base

Step 3

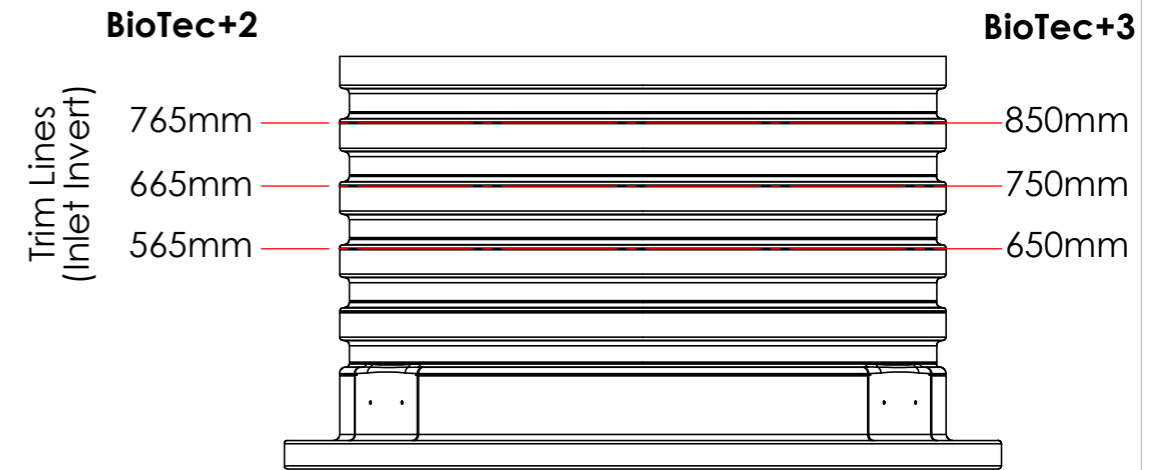

Trim the base of the neck to the required invert as shown above. There are cutting lines on the neck 100mm apart for ease of cutting.

Step 4

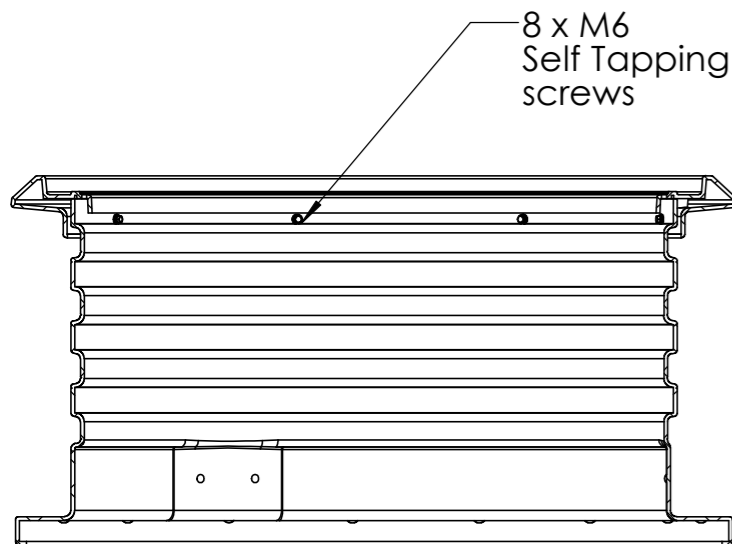

Reposition collar onto the trimmed neck base and fix it in place using M6 self tapping screws.

Step 5

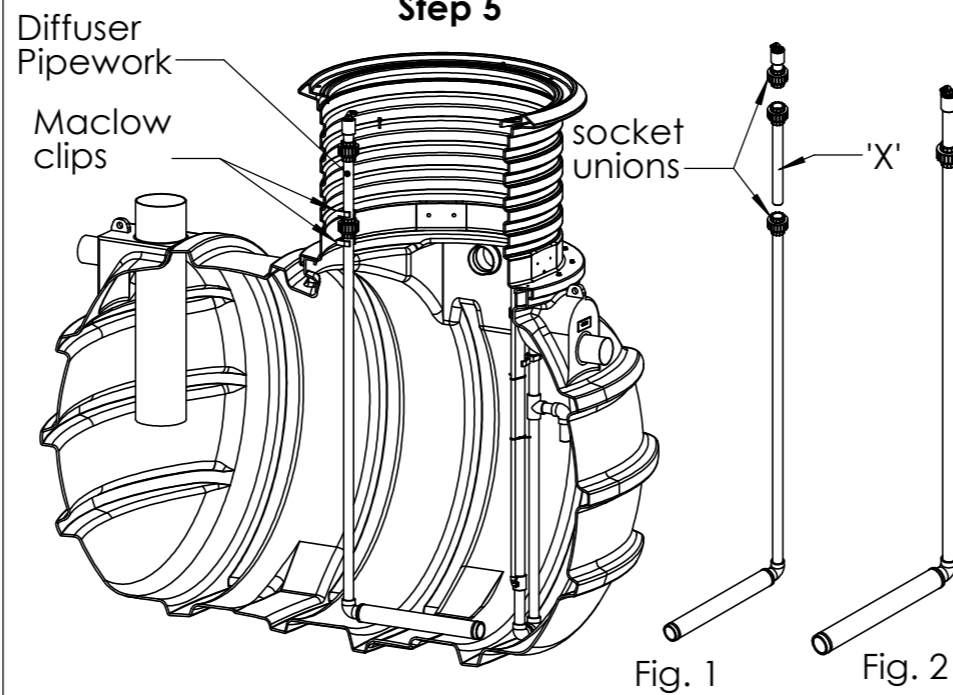

Remove the Diffuser pipework from the tank (Gravity / IPS). Undo socket unions and discard pipe 'X' along with the glued halves of the unions. (Fig. 1) Reassemble the Diffuser pipework and fit it into the tank.(Fig. 2) Fix it on the maclow clips inside the neck of the tank. Replace tank lid.

Step 6

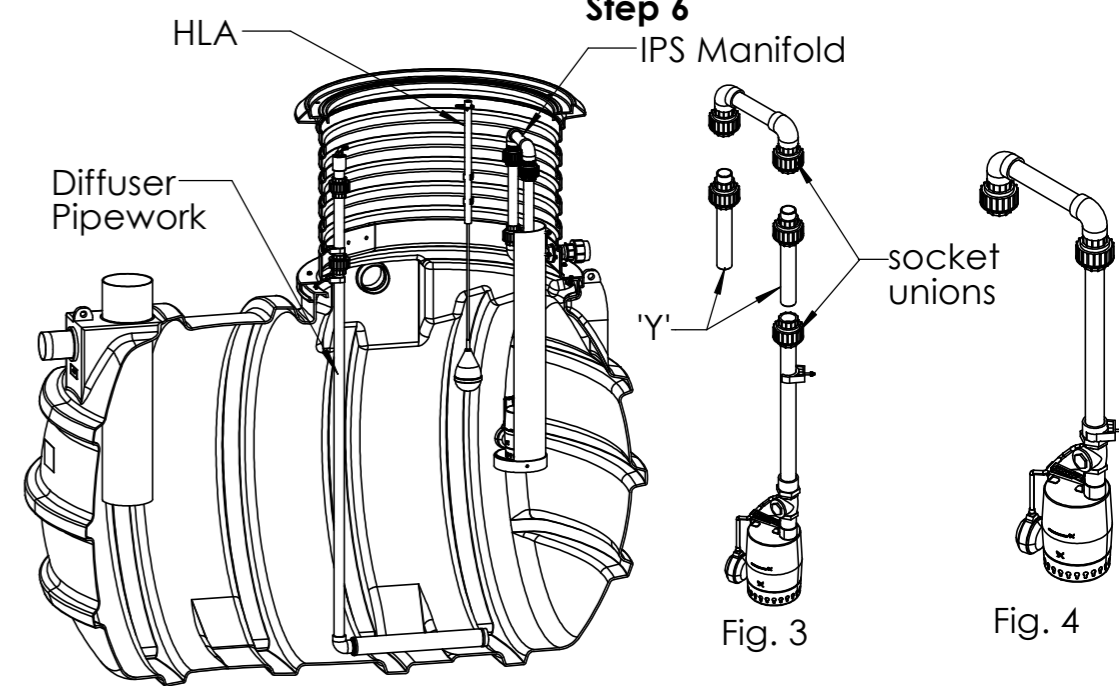

6. Remove the IPS manifold from the tank (IPS) by undoing socket unions and discard 2 OFF pipe 'Y' along with the glued halves of the unions (Fig 3). Reassemble IPS manifold (Fig. 4) and fit it into the tank. Refer to installation guidelines for HLA fitting instructions. Replace tank lid.

Modelled By :
Weight :
Material :

Tolerance (unless stated) :
Thickness :
Surface Area : m²

Drawing : DS1482P

Page 2 of 4

All Dimensions In mm

Scale: Do Not Scale

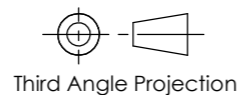

Third Angle Projection

Kingspan Water & Energy reserve the right to alter the details of this drawing without prior notice. This drawing is copyright and may not be reproduced or used without the written permission of Kingspan Water & Energy



BioTec+2 & 3 Neck Extension / Trimming Details

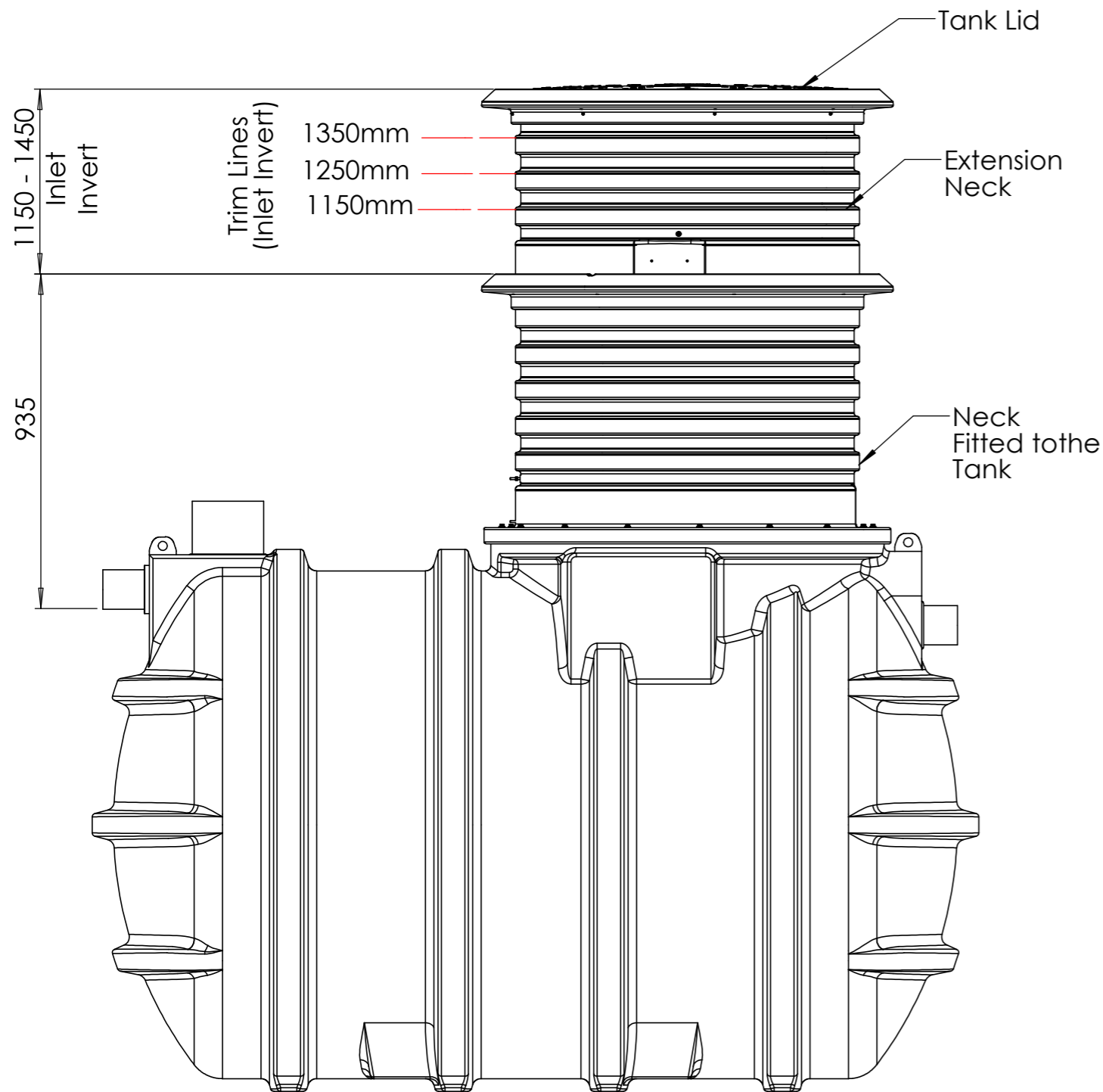

BioTec+ 2

For invert from 1150 mm to 1450mm order :
 1 OFF **BTXEXT2G** for Gravity Tank - LN 1014841
 1 OFF **BTXEXT2P** for IPS Tank - LN 1014878

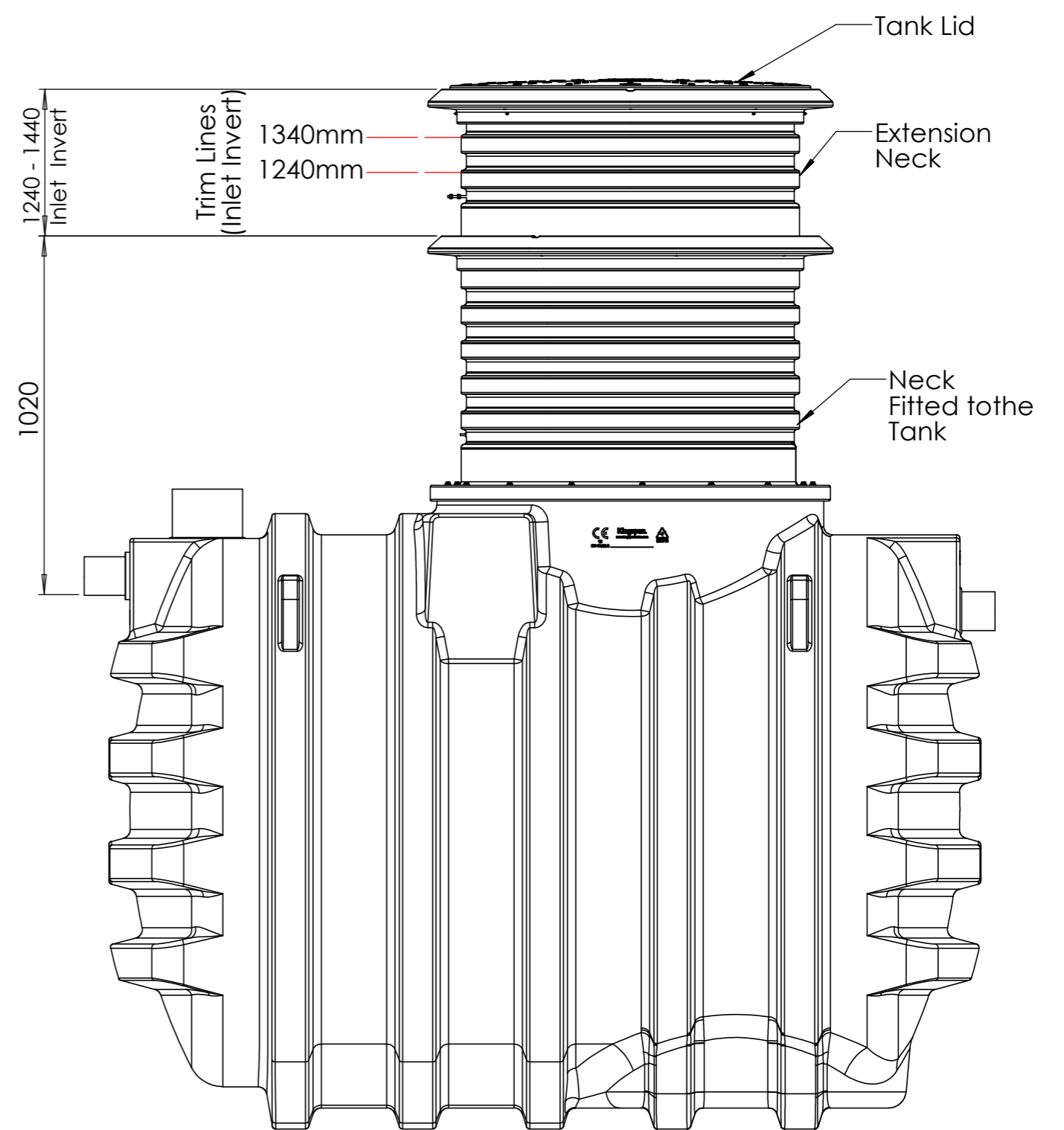

BioTec+ 3

For invert from 1240mm to 1440mm order: 1
 OFF **BTXEXT3G** for Gravity Tank - LN 1014877
 1 OFF **BTXEXT3P** for IPS Tank - LN 1014879

Modelled By :	Tolerance (unless stated) :
Weight :	Thickness :
Material :	Surface Area : m ²

Drawing : DS1482P

All Dimensions In mm Scale: Do Not Scale

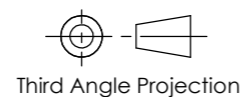

Kingspan Water & Energy reserve the right to alter the details of this drawing without prior notice. This drawing is copyright and may not be reproduced or used without the written permission of Kingspan Water & Energy



Neck Extension Detail

1. Remove the lid supplied with the tank.
2. The neck fitted to the tank is **NOT** removed.
3. On the Extension neck, separate the Extension neck collar from the Extension neck Base by removing the 8 OFF M6 Self Tapping screws (refer to Step 4 on page 2).
4. Trim extension neck to required invert shown on page 3 (refer to Step 3 on page 2).
5. Reposition Extension neck collar onto the trimmed neck base and fix it in place using the 8 Off fixings (refer to Step 4 on page 2).
6. Extension pipework is only required for BioTec+2 1350 & 1450 Inlet inverts.
Extension pipework is only required for BioTec+3 1340 & 1440 Inlet inverts.
7. Where extension of pipework is not required, fit Extension neck to the tank using supplied fixings and sealant.
9. Replace tank lid.

10. Gravity Tank & IPS Tank:
 - Remove the Diffuser pipework from the tank (Fig. 1).
 - Undo top socket union and set aside Hosetail assembly 'Z'.
 - Reassemble the Diffuser pipework with supplied Diffuser extension pipework 'A' and Hosetail assembly 'Z' (Fig. 2).

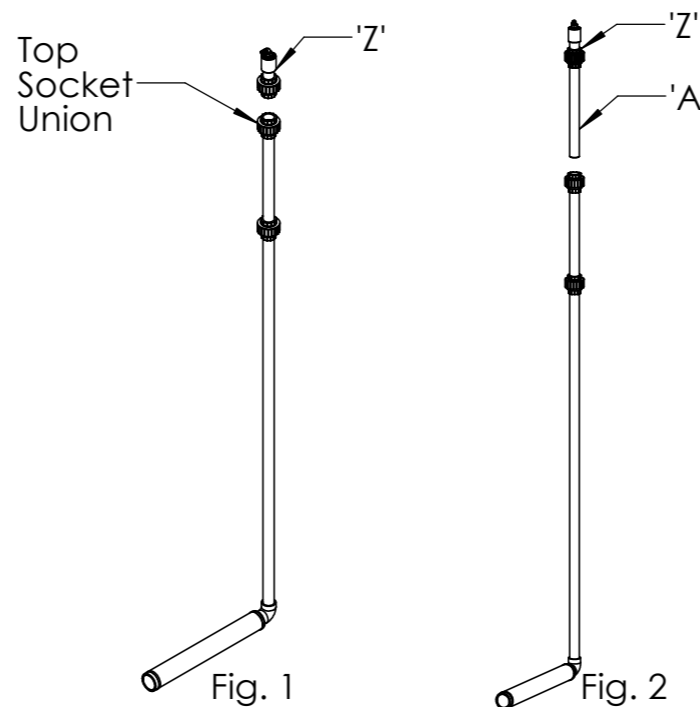

11. Gravity Tank:
 - Remove the Airlift pipework from the tank (Fig. 3).
 - Fit the Airlift extension 'B' onto the Airlift pipework (Fig. 4).

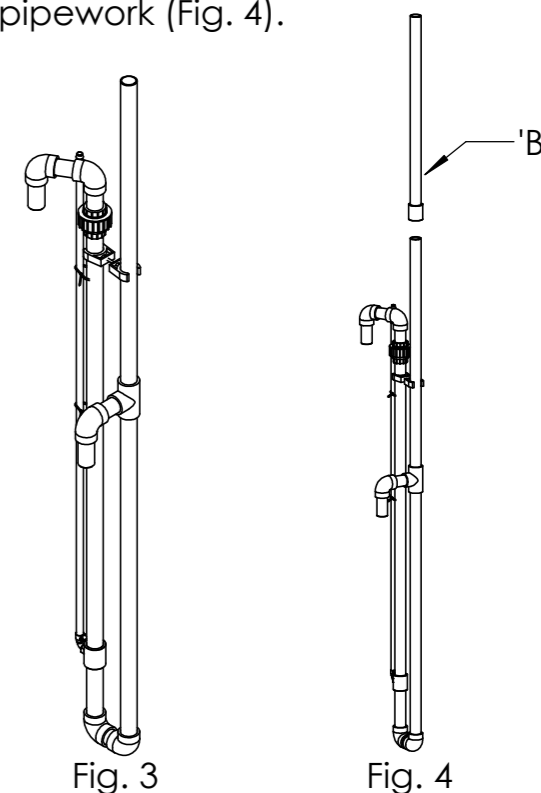

12. IPS Tank:
 - Remove the IPS pipework from the tank.
 - Undo top socket unions and set aside IPS manifold 'C'.
 - Reassemble the IPS pipework with supplied IPS extension pipework 'D' (Fig. 5).

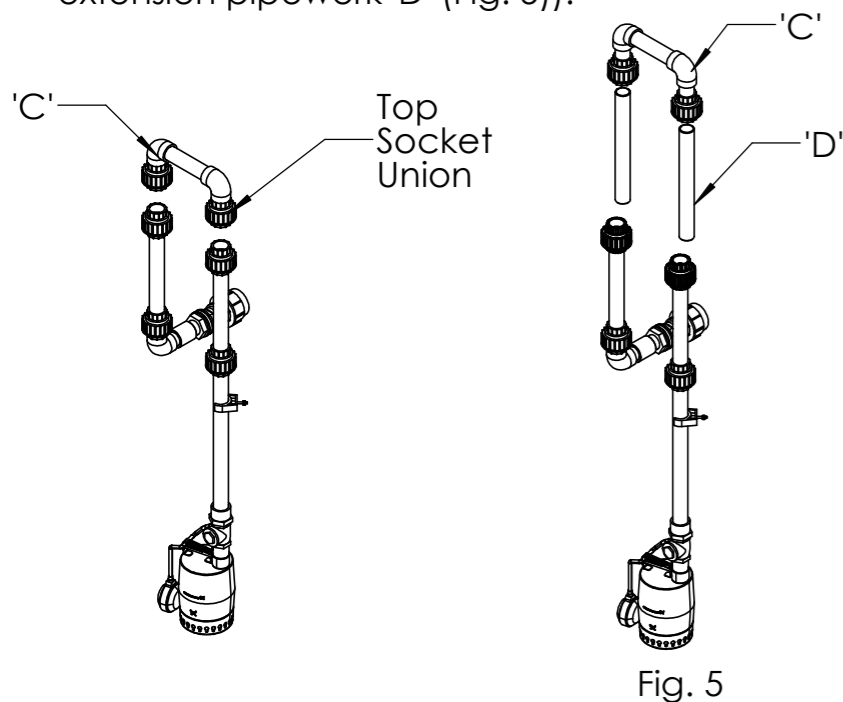

13. Fit Extension Neck onto the neck fitted to the tank using supplied fixings and sealant.
 - Ensure the maclow clip(s) in the extension neck aligns with the maclow clip in the neck fixed to the tank.
 - Fit reworked Diffuser & Airlift pipework (Gravity tank) into the tank and fix on the maclow clips inside the neck of the tank (Fig. 6).
 - Replace the tank lid.

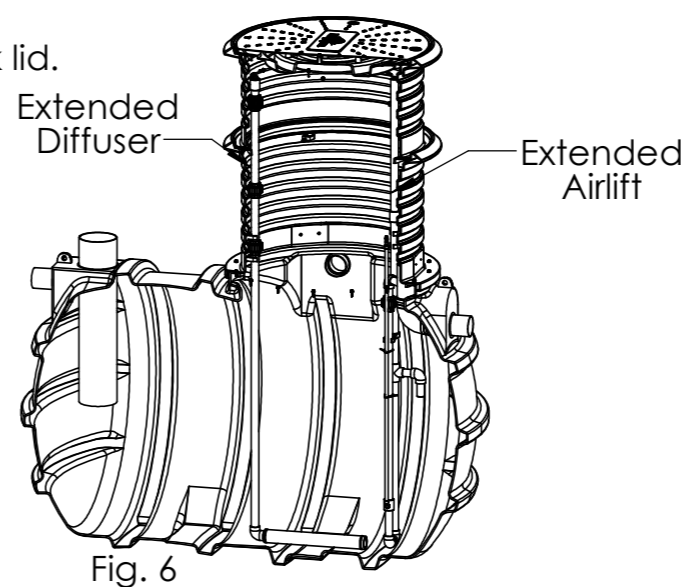

14. Fit reworked Diffuser & IPS pipework (IPS tank) into the tank and fix on the maclow clips inside the neck of the tank (Fig. 7).
 - Replace the Tank Lid.

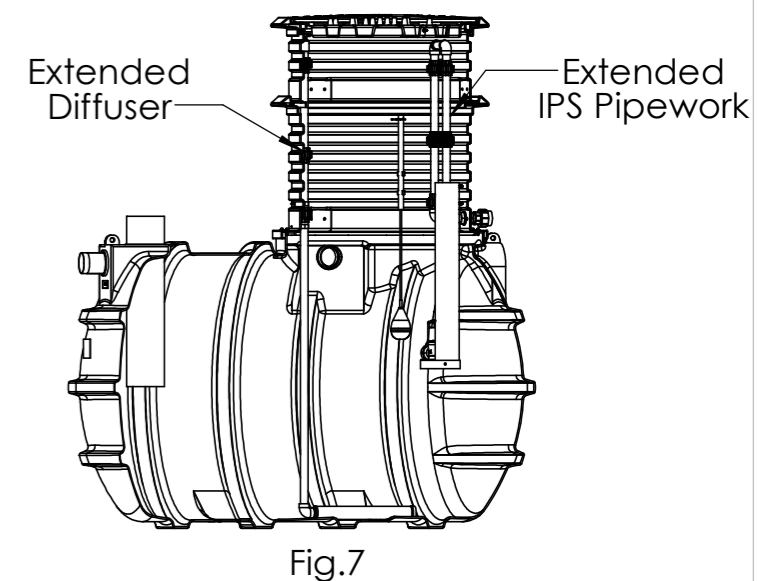

Modelled By :
Weight :
Material :

Tolerance (unless stated) :
Thickness :
Surface Area : m²

Drawing : DS1482P

Page 4 of 4

BioTec+2 & 3 Neck Extension / Trimming Details

All Dimensions In mm

Scale: Do Not Scale

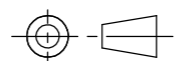

Third Angle Projection

Kingspan Water & Energy reserve the right to alter the details of this drawing without prior notice. This drawing is copyright and may not be reproduced or used without the written permission of Kingspan Water & Energy

