

2075 - External Width

8075 - External Length

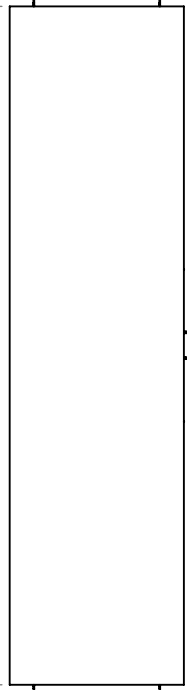

Sloped Roof

3200 - External Height

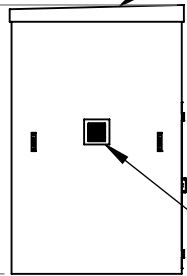

Louvered vent

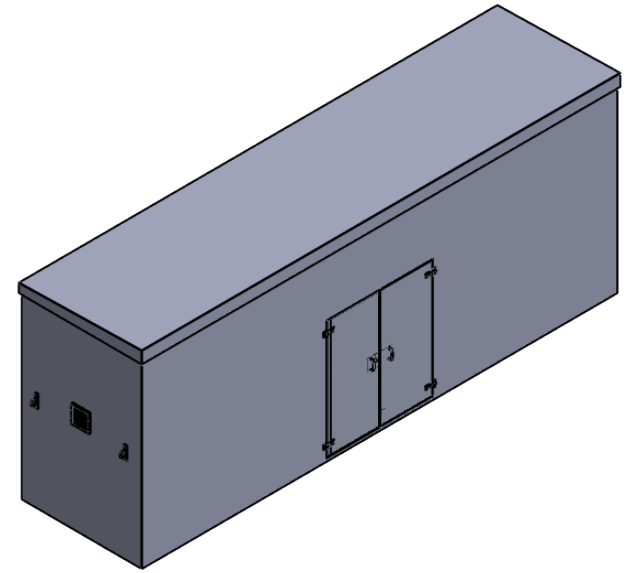

1800 - Door Opening

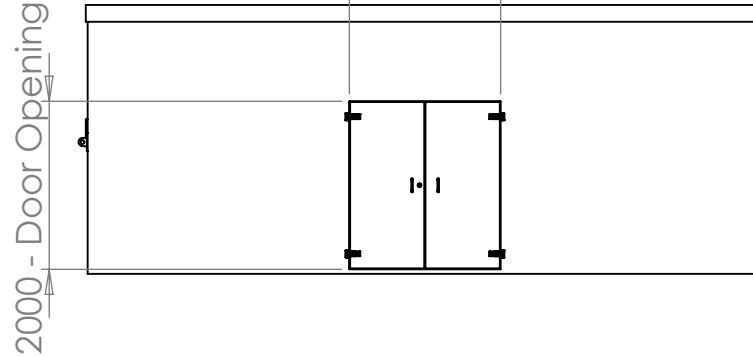

TITLE  
PWHG.8x2x3

DRAWN BY  
C.Larkin

DATE  
23/05/2024

**Foundation Requirements:**  
The foundation area must be no less in length and width than the external dimensions of the enclosure. The foundation must be constructed so as to be capable of supporting the weight of the enclosure and equipment contained within it. The foundation must be continuous and be no more than ±2mm over any given metre.

DESCRIPTION:  
PWHG.8x2x3  
KIOSK

SCALE:1:90 SHEET 1 OF 2

TANK SPECIFICATION :

INTERNAL DIMENSIONS	7860 x 1860 x 3000mm
EXTERNAL DIMENSIONS	8075 x 2075 x 3200mm
INSULATION THICKNESS	18mm
MATERIAL	GRP - GREY



2075 - External Width

8075 - External Length

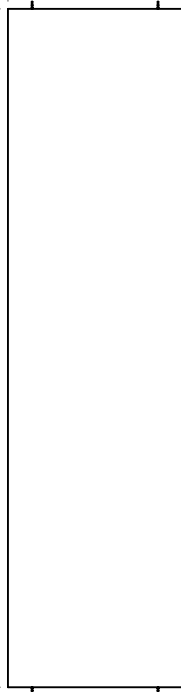

Sloped Roof

3200 - External Height

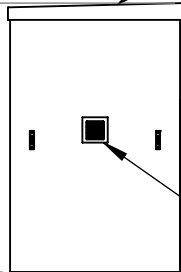

Louvered vent

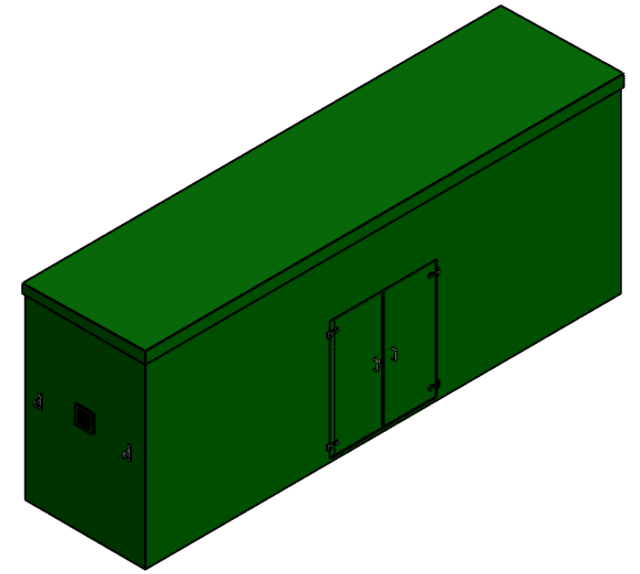

1800 - Door Opening

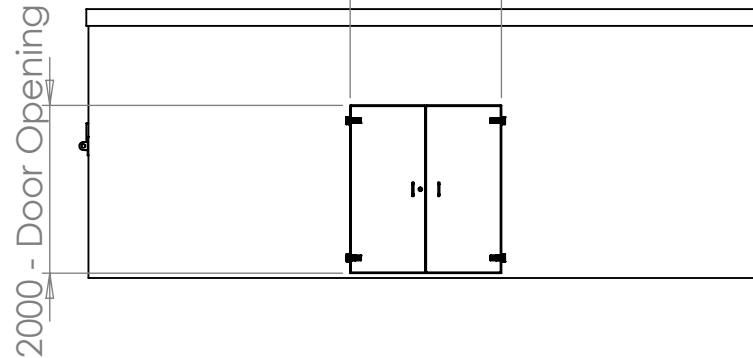

TITLE

PWHG.8x2x3

DRAWN BY: C.Larkin DATE: 23/05/2024

Foundation Requirements:

The foundation area must be no less in length and width than the external dimensions of the enclosure. The foundation must be constructed so as to be capable of supporting the weight of the enclosure and equipment contained within it. The foundation must be continuous and be no more than ±2mm over any given metre.

DESCRIPTION:

PWHG.8x2x3

KIOSK

SCALE:1:90

SHEET 2 OF 2

TANK SPECIFICATION :

INTERNAL DIMENSIONS	7860 x 1860 x 3000mm
EXTERNAL DIMENSIONS	8075 x 2075 x 3200mm
INSULATION THICKNESS	18mm
MATERIAL	GRP - GREEN

